

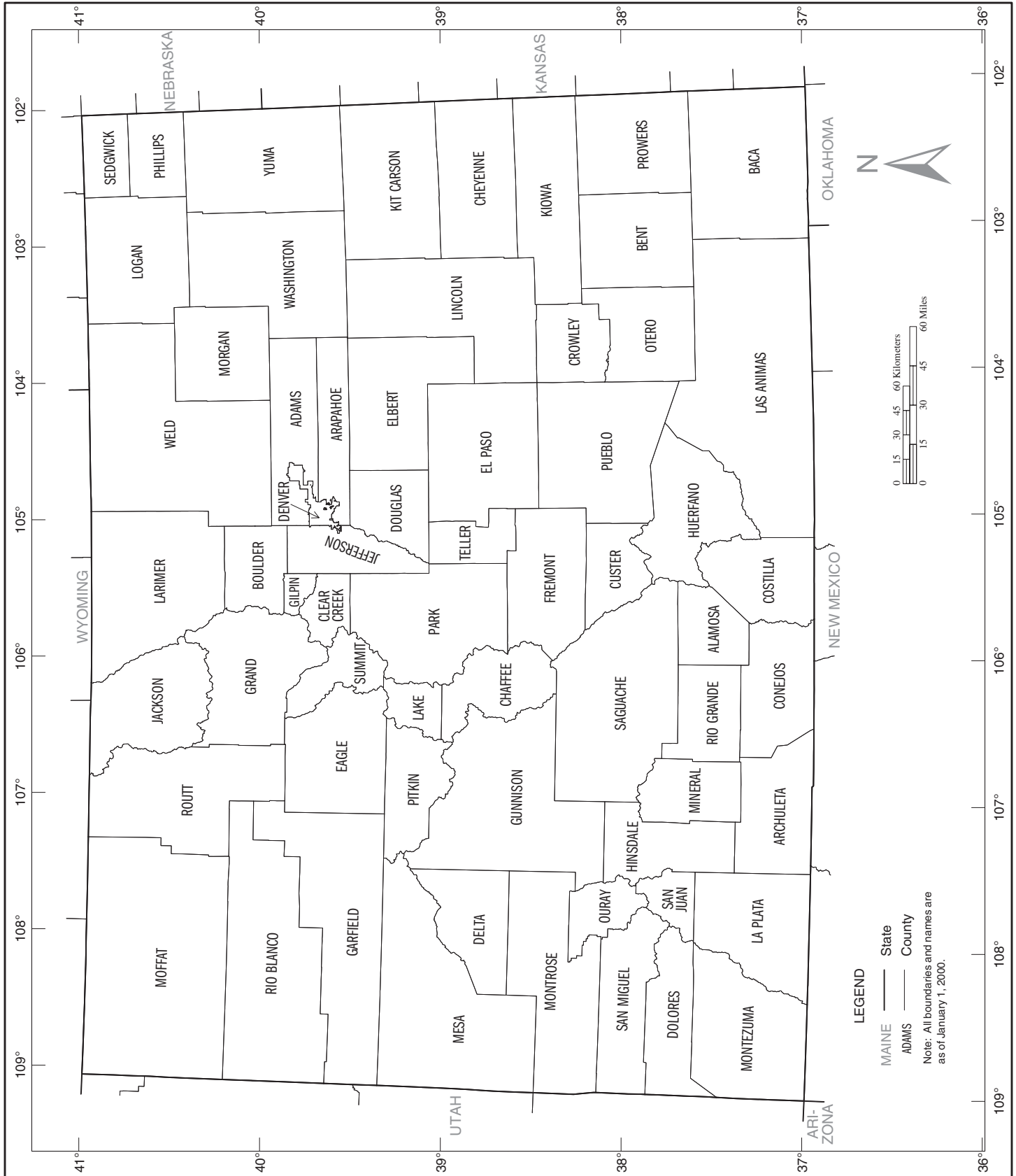







Appendix F. Maps

Counties



County Subdivision Outline Map Legend and County Location Index

Map Legend

| | | |
|---|--------------|--|
|  | CAMPO | American Indian Reservation (Federal) |
|  | | State |
|  | ERIE | County |
|  | YORK | County Subdivision ¹ |
|  | ROME | Incorporated Place ¹ |
|  | Zena | Census Designated Place |
|  | Lake Erie | Large River, Lake, Water Body, or Shoreline |
|  | | A fishhook joins contiguous and/or discontinuous parts of the same geographic entity |

Map Sections

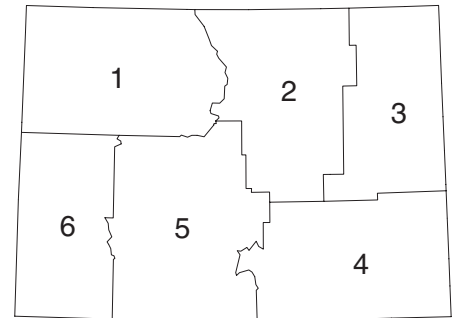

¹ A "*" following a place name indicates that the place is coextensive with a separate county subdivision. The county subdivision name is shown only if different than the name of the place.

Note: All legal boundaries and names are as of January 1, 2000. Where state, county, and/or county subdivision boundaries coincide, the map shows the boundary symbol for the highest level of these geographic entities. The county boundary is always shown. Where a county subdivision boundary coincides with a place boundary, the map does not show the place boundary symbol. Any geographic entity name may include '(pt.)' if some portion of the entity extends beyond the limits of the map area displayed on the page, or if multiple discontinuous pieces of the entity have been discretely labeled on the page. A geographic entity name may include '(pts.)' if many discontinuous pieces exist for that entity that cannot be discretely labeled. The boundaries shown on this map are for Census Bureau statistical data collection and tabulation purposes only; their depiction and designation for statistical purposes does not constitute a determination of jurisdictional authority or rights of ownership or entitlement.

County Location Index

This list presents the reference coordinates for each county on the county subdivision outline map. Map section numbers refer to the county subdivision outline maps only.

| COUNTY | MAP SEC | MAP REF | COUNTY | MAP SEC | MAP REF | COUNTY | MAP SEC | MAP REF |
|------------------|---------|---------|-----------------|---------|---------|-----------------|---------|---------|
| Adams..... | 2 | ET-CC | Kiowa..... | 4 | FD-CL | Washington..... | 3 | FA-CC |
| Alamosa..... | 5 | EL-CQ | Kit Carson..... | 3 | FE-CG | Weld..... | 2 | ET-BY |
| Arapahoe..... | 2 | ET-CE | La Plata..... | 6 | DY-CS | Yuma..... | 3 | FF-CB |
| Archuleta..... | 5 | ED-CS | Lake..... | 5 | EH-CG | | | |
| Baca..... | 4 | FE-CS | Larimer..... | 2 | EN-BY | | | |
| Bent..... | 4 | FB-CO | Las Animas..... | 4 | EV-CS | | | |
| Boulder..... | 2 | EN-CB | Lincoln..... | 3 | EY-CI | | | |
| Chaffee..... | 5 | EI-CJ | Logan..... | 3 | FB-BX | | | |
| Cheyenne..... | 3 | FE-CJ | Mesa..... | 6 | DV-CH | | | |
| Clear Creek..... | 2 | EM-CD | Mineral..... | 5 | EE-CP | | | |
| Conejos..... | 5 | EI-CS | Moffat..... | 1 | DW-BY | | | |
| Costilla..... | 5 | EN-CS | Montezuma..... | 6 | DU-CR | | | |
| Crowley..... | 4 | EX-CM | Montrose..... | 6 | DW-CL | | | |
| Custer..... | 5 | EN-CN | Morgan..... | 2 | EX-CA | | | |
| Delta..... | 6 | DY-CI | Otero..... | 4 | EX-CO | | | |
| Denver..... | 2 | EQ-CD | Ouray..... | 6 | DZ-CN | | | |
| Dolores..... | 6 | DU-CP | Park..... | 5 | EL-CH | | | |
| Douglas..... | 2 | EQ-CG | Phillips..... | 3 | FF-BY | | | |
| Eagle..... | 1 | EF-CE | Pitkin..... | 5 | EE-CG | | | |
| El Paso..... | 2 | ES-CJ | Prowers..... | 4 | FF-CO | | | |
| Elbert..... | 2 | EV-CG | Pueblo..... | 4 | ES-CM | | | |
| Fremont..... | 5 | EN-CL | Rio Blanco..... | 1 | DW-CC | | | |
| Garfield..... | 1 | DY-CE | Rio Grande..... | 5 | EH-CQ | | | |
| Gilpin..... | 2 | EM-CC | Routt..... | 1 | EE-BZ | | | |
| Grand..... | 1 | EJ-CB | Saguache..... | 5 | EI-CN | | | |
| Gunnison..... | 5 | ED-CK | San Juan..... | 6 | DZ-CP | | | |
| Hinsdale..... | 5 | EC-CP | San Miguel..... | 6 | DV-CN | | | |
| Huerfano..... | 4 | EQ-CP | Sedgwick..... | 3 | FF-BW | | | |
| Jackson..... | 1 | EH-BY | Summit..... | 1 | EJ-CE | | | |
| Jefferson..... | 2 | EO-CE | Teller..... | 2 | EP-CI | | | |

American Indian Areas, Counties, County Subdivisions, and Places - Section 1

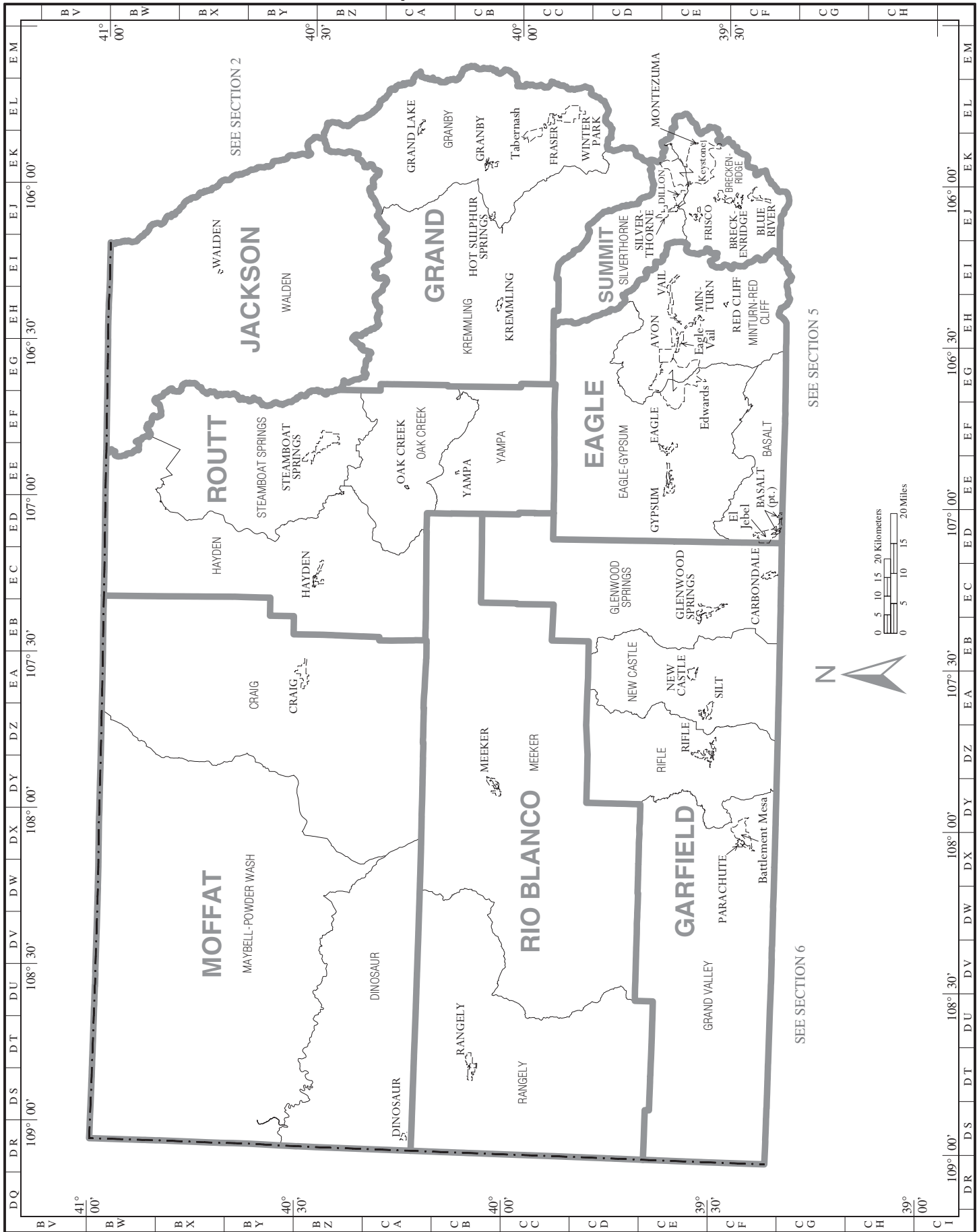

American Indian Areas, Counties, County Subdivisions, and Places – Section 2

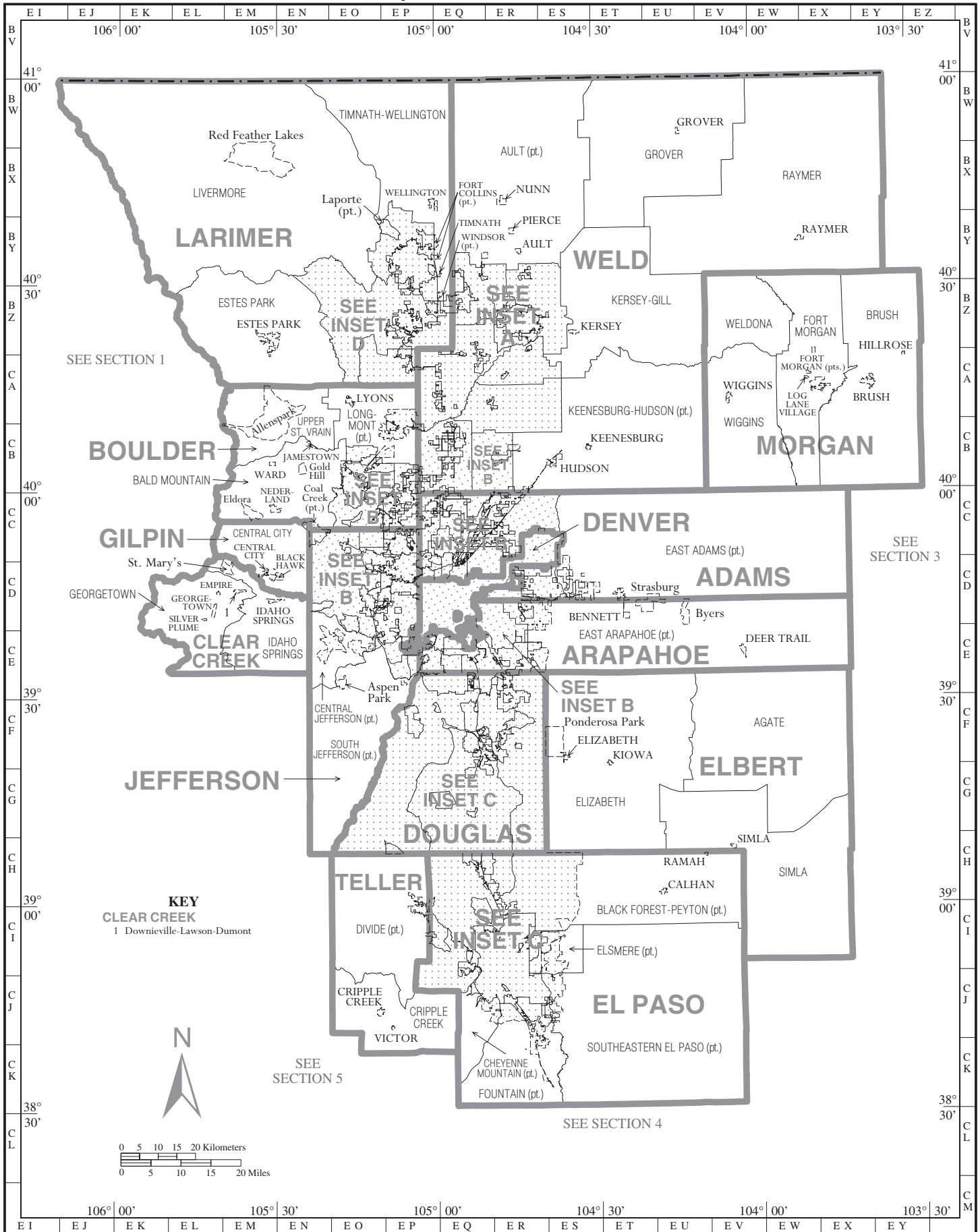

American Indian Areas, Counties, County Subdivisions, and Places – Section 3

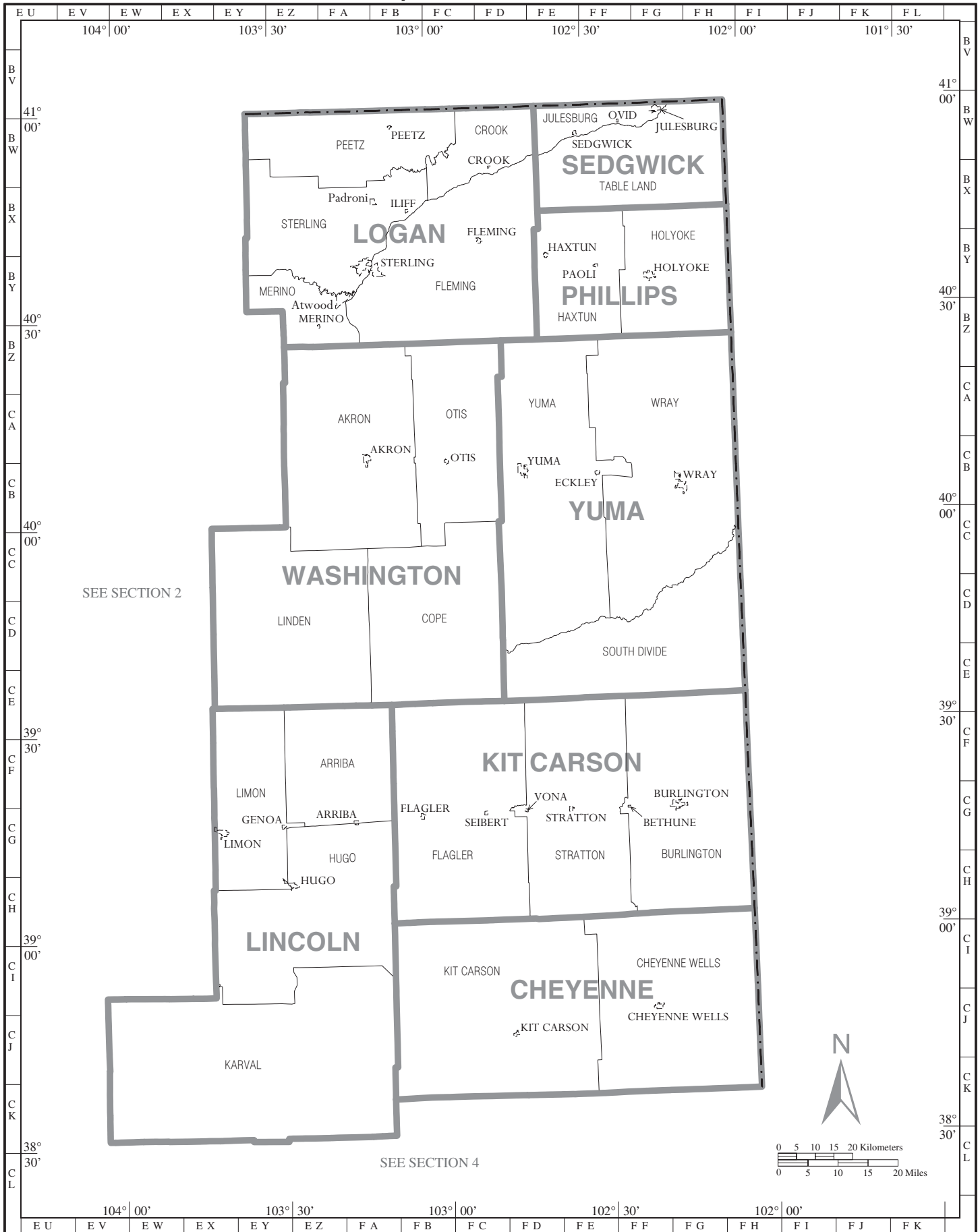

American Indian Areas, Counties, County Subdivisions, and Places – Section 4

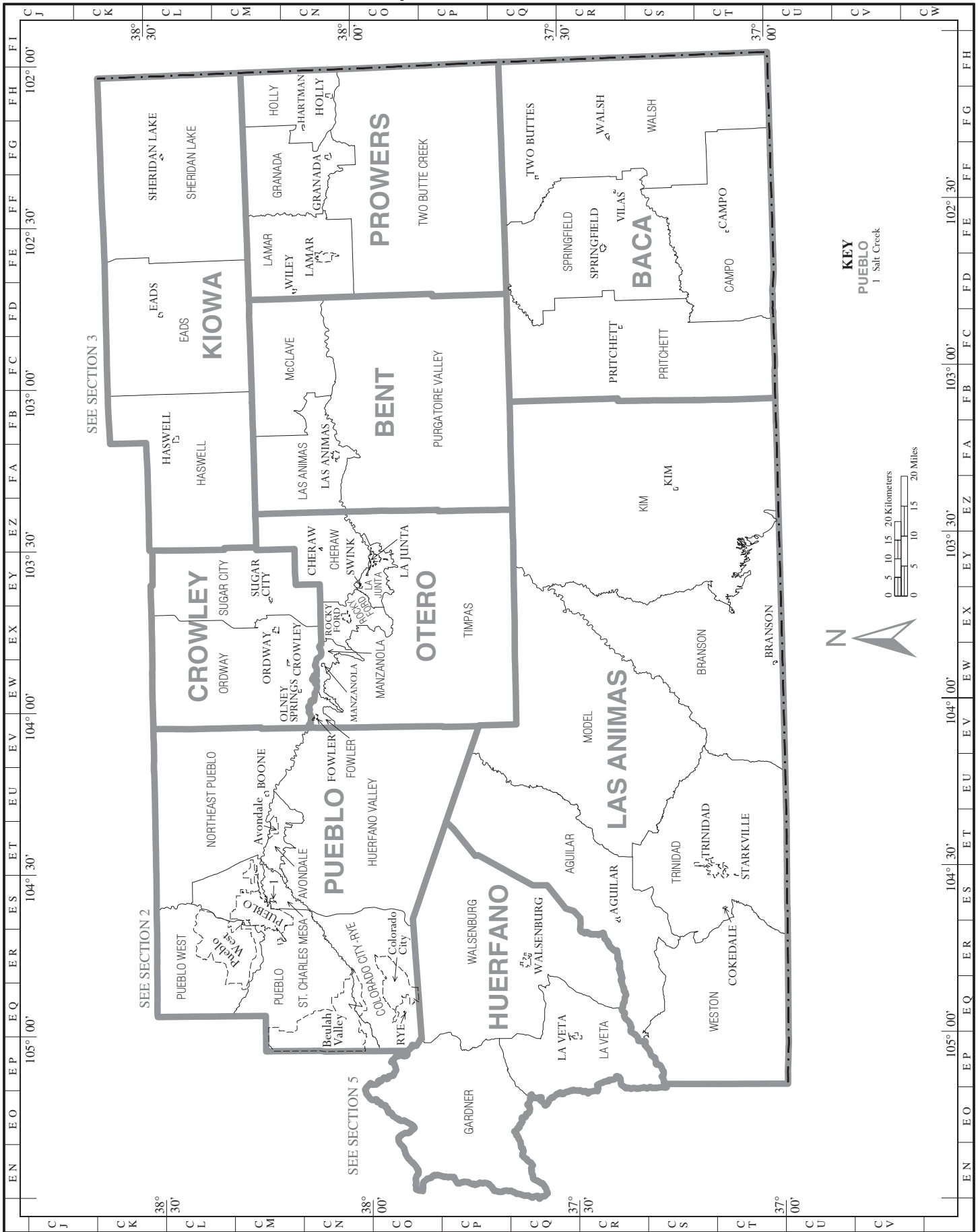

American Indian Areas, Counties, County Subdivisions, and Places – Section 5



American Indian Areas, Counties, County Subdivisions, and Places – Section 6

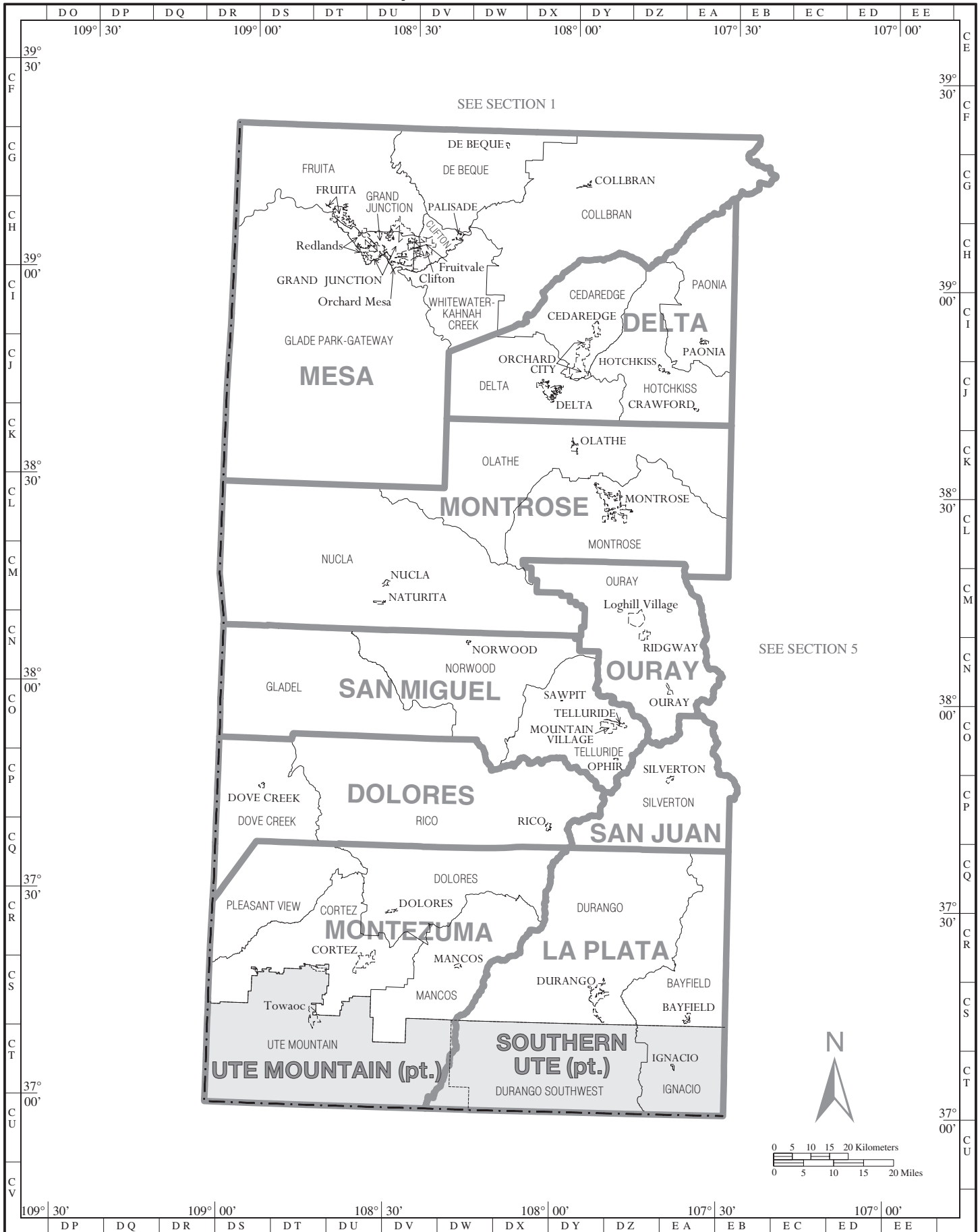

American Indian Areas, Counties, County Subdivisions, and Places – Inset A

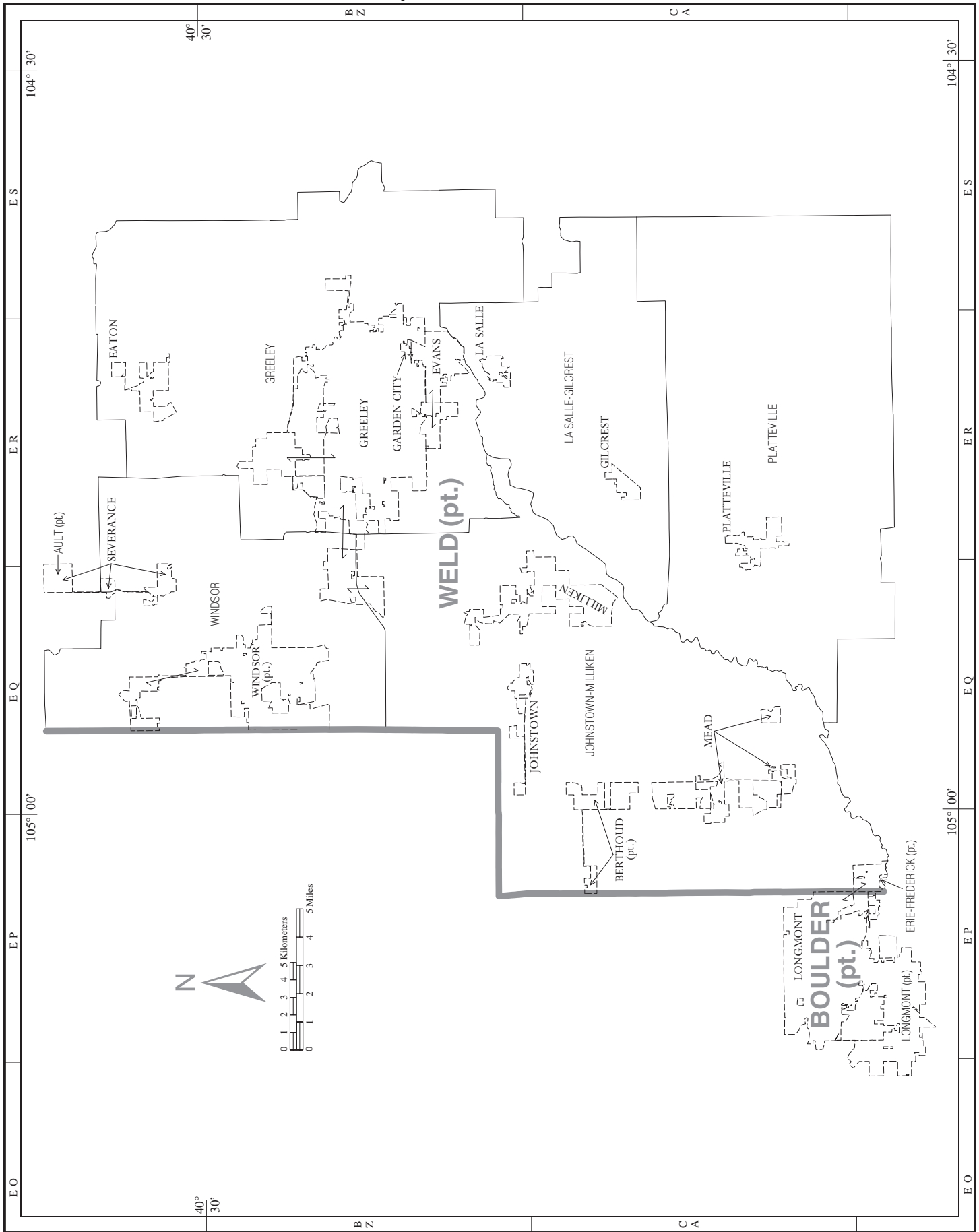

American Indian Areas, Counties, County Subdivisions, and Places – Inset D

